



INSTRUCTION BULLETIN

No. 340252
Machine: 6200
Published: 9-99/00
System: OPTIONS

NOTE: DO NOT DISCARD the Parts List from the Instruction Bulletin. Place the Parts List in the appropriate place in your machine manual for future reference. Retaining the Parts List will make it easier to reorder individual parts and will save you the cost of ordering an entire kit.

NOTE: Numbers in parenthesis () are reference numbers for parts listed in Bill of Materials.

Installation instructions for kit number 384063

SYNOPSIS / PROBLEM:

This kit contains the parts needed to install an operating lights kit on the model 6200 sweeper.

Please follow step-by-step instructions.

SPECIAL TOOLS / CONSIDERATIONS: NONE

(Estimated time to complete: 1 hour)

PREPARATION:

(Refer to FIG. 1 thru 4)

FOR SAFETY: Before leaving or servicing machine, stop on level surface and set parking brake. Then turn off machine and remove key.

1. Unlatch and remove the hopper cover.
2. Turn the machine power on, and raise hopper approximately twelve inches off the floor.
3. Raise the operator's seat. Disconnect battery cables from machine.
4. Locate headlight and taillight mounting locations in the front and rear of the machine.



WARNING: Always disconnect battery cables from machine before working on electrical components.

INSTALLATION:

(Refer to FIG. 1 thru 4)

NOTE: If your machine is already equipped with the warning light package, proceed to step number 5. Keep switch 360520 and circuit breaker 383722 as spare parts.

1. Open the circuit breaker panel. (Refer to FIG. 1)
2. Install the new circuit breaker (6) in the panel. Wire the circuit breaker (6) into the main harness. (Refer to FIG. 1 and 4)
3. Remove the standard light switch in the control panel, and unplug it from the wiring harness. (Refer to FIG. 1)
4. Plug the new switch (5) into the wiring harness, and snap it into place in the control panel. (Refer to FIG. 1 and 4)

5. Mount the two headlights (1) in the front mounting locations and connect them to the wiring harness. Connect the 13H/13J Black and 47/47A Purple to the RH headlight. Connect the 13N/13M Black and 47A/47B Purple to the LH headlight. (Refer to FIG. 1 and 4)
6. Locate the mounting position for the resistor (7) on the left side of the hopper as shown in figure 1. (Refer to FIG. 1)
7. Remove the rear bumper from the rear of the machine. Set mounting hardware aside.
8. Mount the resistor (7) to the machine with two hex screws (8). (Refer to FIG. 1)
9. Mount two tail light assemblies (2) to the rear mounting locations with four hex nuts (4). (Refer to FIG. 1 and 3)
10. Mount the tail light harness (3) into position along the back of the hopper with three cable ties (10) and cable tie mounts (9) approximately four inches from the bottom of the hopper. (Refer to FIG. 1 and 2)
11. Connect tail lights (9) to the tail light harness(3). Bundle the extra tail light harness (3) at each tail light (2) with cable ties (10). Hold the bundles in position with cable tie mounts (9). (Refer to FIG. 1 and 3)
12. Connect the resistor (7) and the tail light harness (3) to the main harness. (Refer to FIG. 4)
13. Reconnect the batteries to the machine. Check the front and rear operating lights for proper operation.
14. Replace the rear bumper with set aside mounting hardware.
15. Lower the debris hopper to the fully closed position.
16. Replace and secure the debris hopper cover.

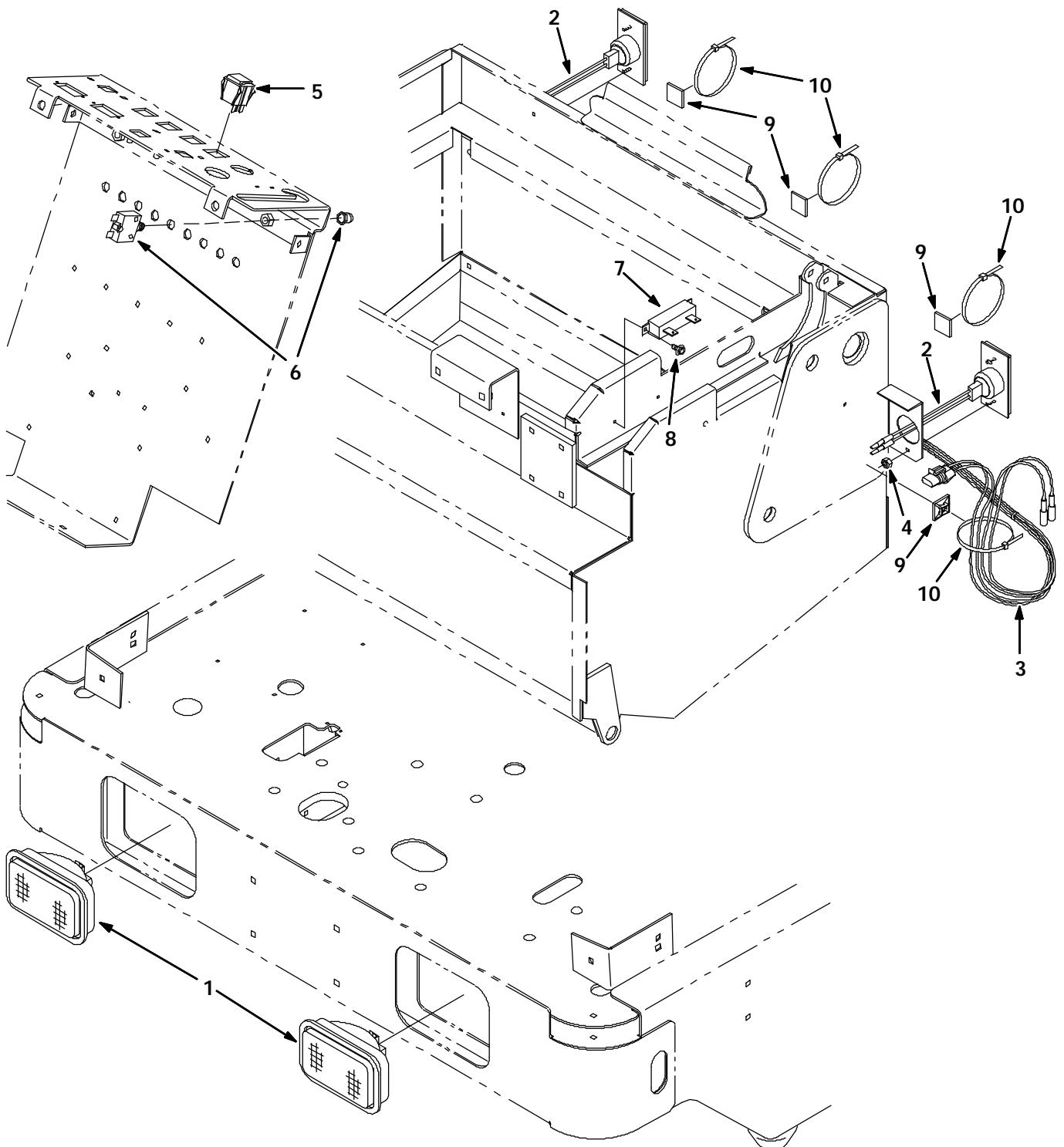
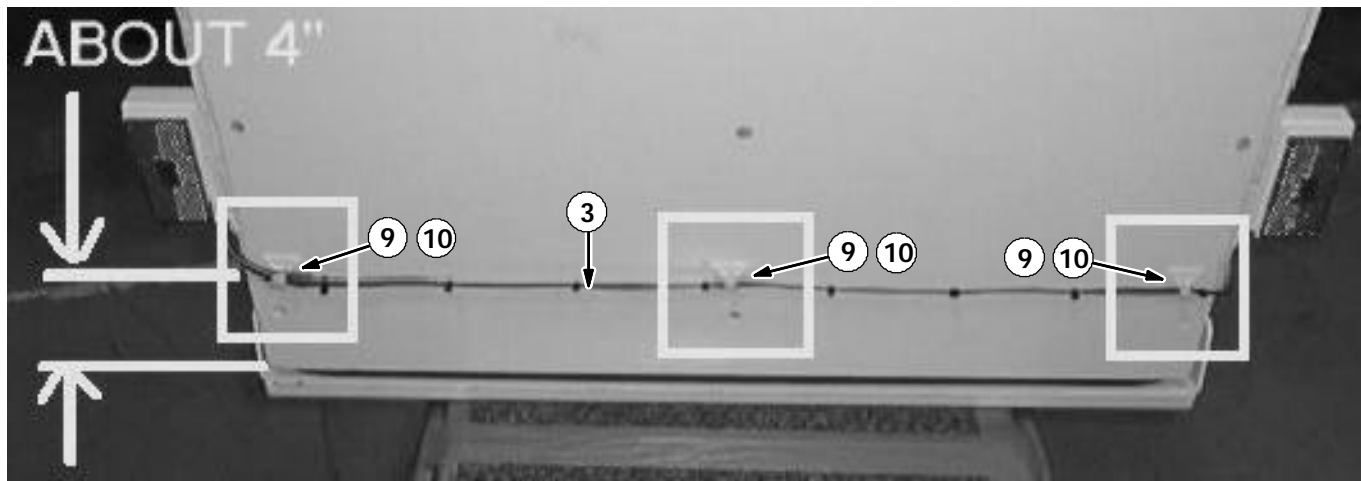
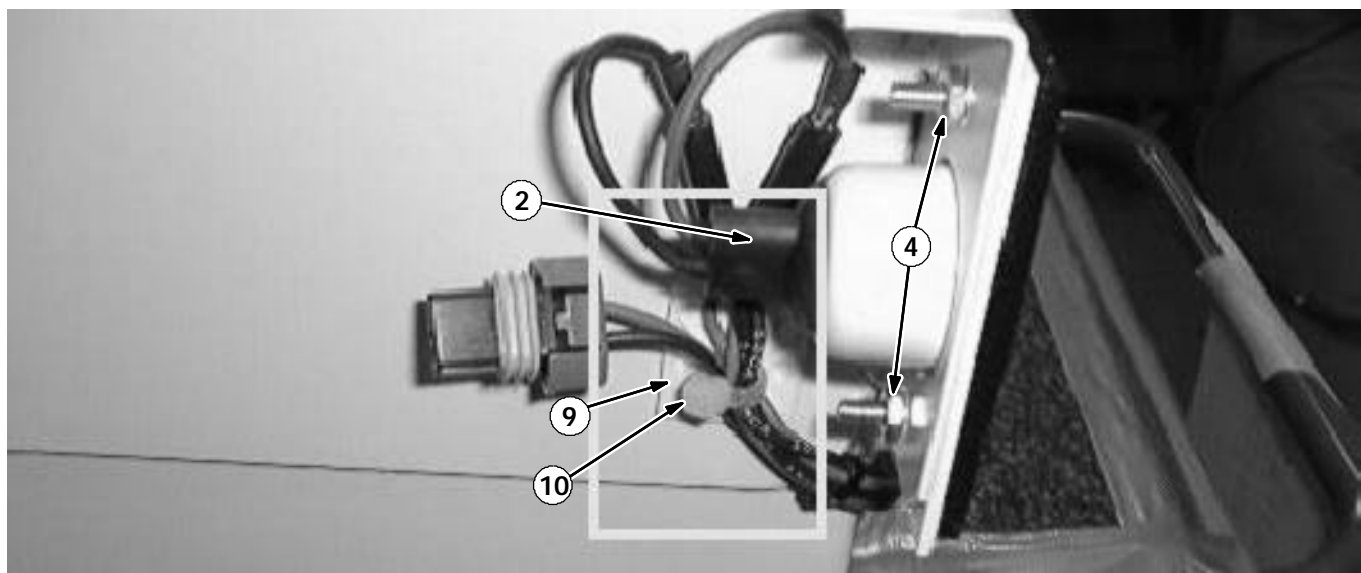

FIG. 1 - HEADLIGHT KIT INSTALLATION



SET TAIL LIGHT WIRE HARNESS INTO POSITION ABOUT FOUR INCHES FROM THE BOTTOM OF THE MACHINE WITH WIRE TIES AND WIRE TIE MOUNTS.

FIG. 2 - TAIL LIGHT HARNESS INSTALLATION



BUNDLE EXCESS WIRE HARNESS WITH WIRE TIES AND WIRE TIE MOUNTS.

FIG. 3 - TAIL LIGHT HARNESS INSTALLATION

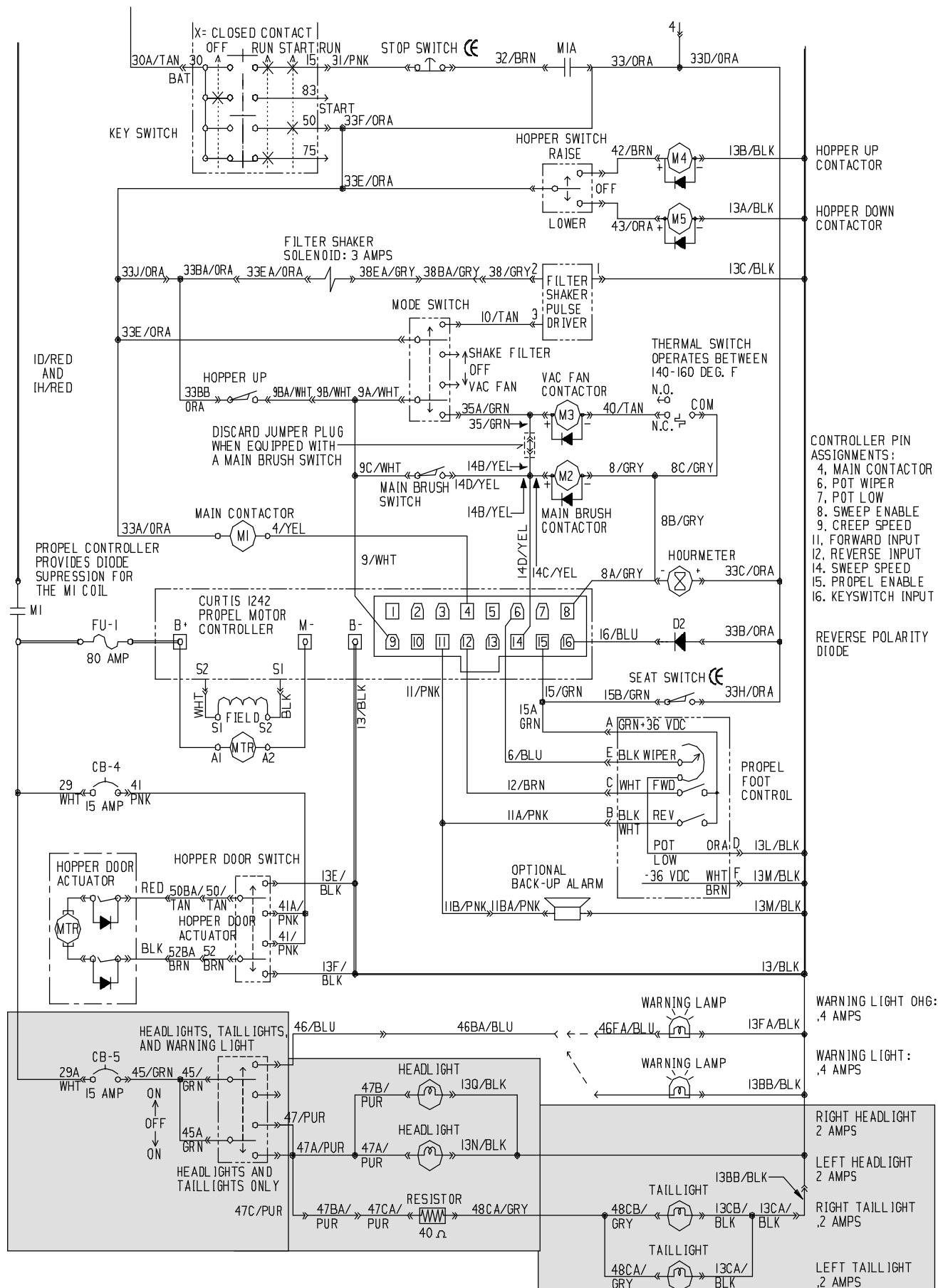

FIG. 4 - 6200 ELECTRICAL SCHEMATIC

BILL OF MATERIALS FOR HEADLIGHT KIT 384063

Ref.	TENNANT Part No.	Description	Qty.
1	383894	Headlight, 36Vdc	2
2	87346	Light Assy Tail	2
3	383836	Harness, Taillight, 6200	1
4	01713	Nut, Hex, Std, #10-32, G2	4
5	360520	Switch, Rocker, Spdt, 3Pos	1
6	383722	Circuitbreaker, 15Amp	1
7	87349	Resistor	1
8	223198	Screw, Hex	2
9	55248	Mount, Cable Tie	5
10	49266	Tie, Cable 1.75D Max 7.50Lg	5

TENNANT COMPANY
P. O. Box 1452
Minneapolis, MN 55440-1452